



Plan of Survey  
Showing  
SURFACE SUBDIVISION  
of Part of Parcel A  
Plan No. 101147633  
In S.E.1/4 Sec. 33  
Twp.17 Rge. 20 W.2Mer.  
Regina, Saskatchewan  
Guy Craig, s.l.s.  
May, 2008 - June, 2008  
Scale 1:1000

**Note**  
Measurements are in metres and decimals thereof.  
Area to be approved is outlined by a bold dashed line.  
Parcels within the line of approval have an extension 0.  
All standard iron posts planted are marked with S045.  
Lot corners are marked by 0.013 x 0.450 iron post  
unless otherwise shown.

**Legend**  
Standard iron posts found are shown thus ————  
Standard iron posts planted are shown thus ————

Title to Dedicated Lands are to be issued to the  
City of Regina.

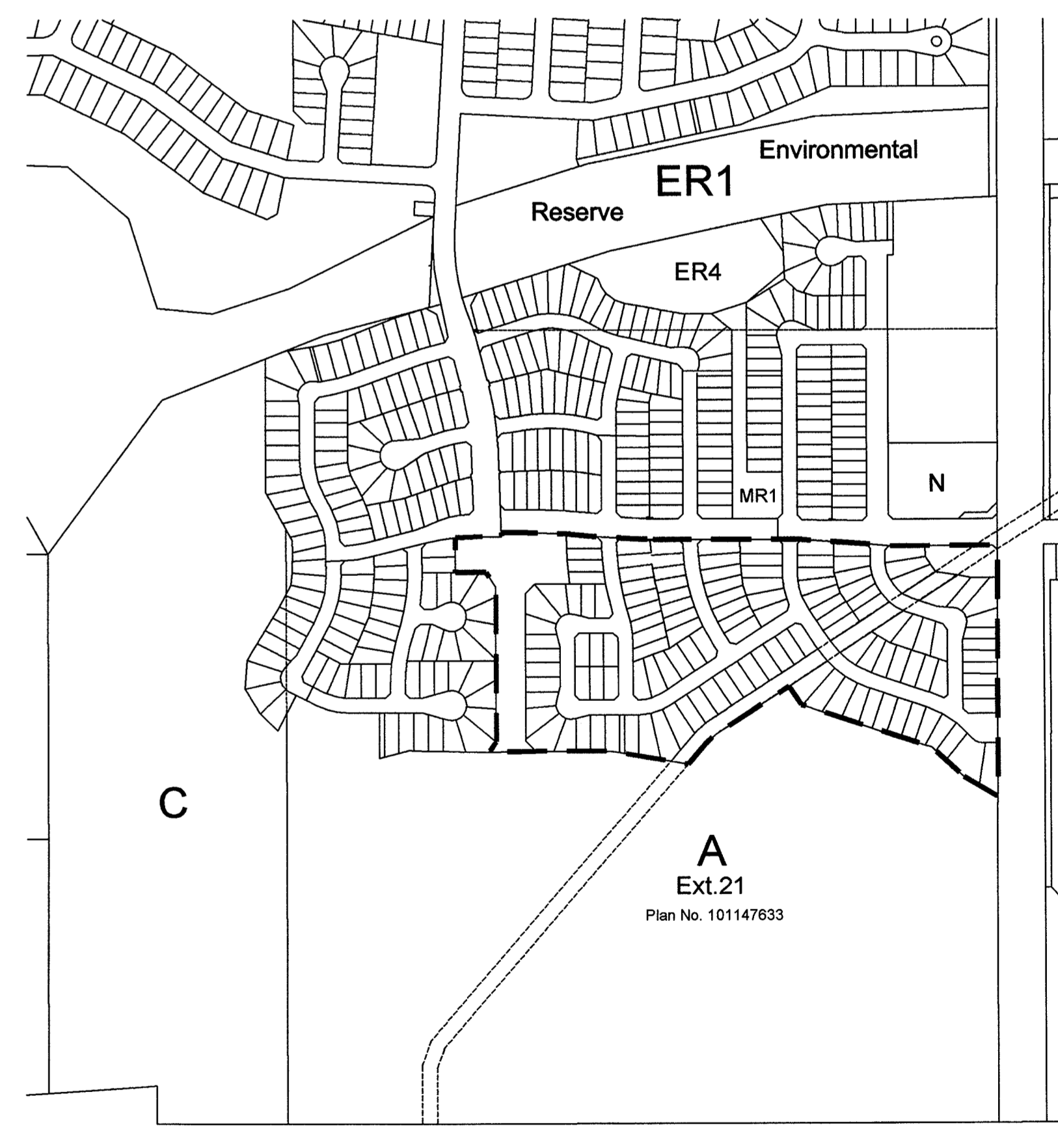

Key Plan